



Royal's Farm

YOUR WEEKEND FARM HOUSE



Ghanpur Village, Kangti Mandal,
Sangareddy Dist (Narayankhed)



JMK'S ROYAL'S FARM

Plan for the Future

The JMK's Royal's Farm is only 9 kilometres from the Nanded Highway and has a pleasant, lush green environment.

JMK's Royals Farm is a thoughtful selection of gated community Farm plots Project, a destination purposefully chosen for its connectively and potential growth. Our project is close to Nanded National Highway and connects the area to National Investment Manufacturing Zone (NIMZ) and ultimately to core areas.

PROJECT HIGHLIGHTS

- 20 acres of the project to be extended to 40 acres.
- Sandalwood Farmland Project with Fruit Plants.
- The project comes up with a clubhouse, cottages, swimming pool, children's play area, food court, coffee bar and much more!
- The entrance arch and diamond mesh fencing will serve as the project's security, with CCTV monitoring and 24-hour security.
- The roads in the project are 30- and 20-foot gravel roads.
- We cultivate sandalwood crop by using all scientific methods, such as the distance between each plant, host plants, adjusting soil PH levels, and using fertilizers.
- All our projects will be overseen by Agri experts to ensure a high yield in a short period of time!



Plot Size & Plantations!

Type of Plants	No. of Plants
----------------	---------------

605 Sq. Yards (5 Gunta)

Sandalwood	50
------------	----

Fruit Plants	20
--------------	----

1210 Sq. Yards (10 Gunta)

Sandalwood	100
------------	-----

Fruit Plants	40
--------------	----

2420 Sq. Yards (Half Acre)

Sandalwood	200
------------	-----

Fruit Plants	80
--------------	----

4840 Sq. Yards (One Acre)

Sandalwood	400
------------	-----

Fruit Plants	160
--------------	-----

* If the Customer wish to build the Cottage in his/her land, he must inform the company on the day of booking as the land for cottage construction should be left without plantation.



JMK's Royals Farm is a thoughtful selection of gated community Farm plots Project, a destination purposefully chosen for its connectivity and potential growth. Our Project is close to Nanded National Highway and connects the area to National Investment Manufacturing Zone (NIMZ) and ultimately to core areas.

CLUB HOUSE:

Royal's Club - The Club house extends up to 2674 Sq. Yards with Great amenities like Yoga Center, Cycling Track, Swimming Pool, Shuttle Court, Children Play area, Coffee bar, Restaurant & much more!

COTTAGES :

- 5 Cottages
- 1 BHK & 2 BHK Cottages
- Safe & Secured Cottage
- Free Stay with Club Membership*

FOOD COURT & COFFEE BAR

Life time Club Memberships

~~₹60,000~~ ₹29,999 only

FEATURES

- Life time validity
- 6 Days free Stay p.a.
- Unlimited Fun
- Upto 25% on Food

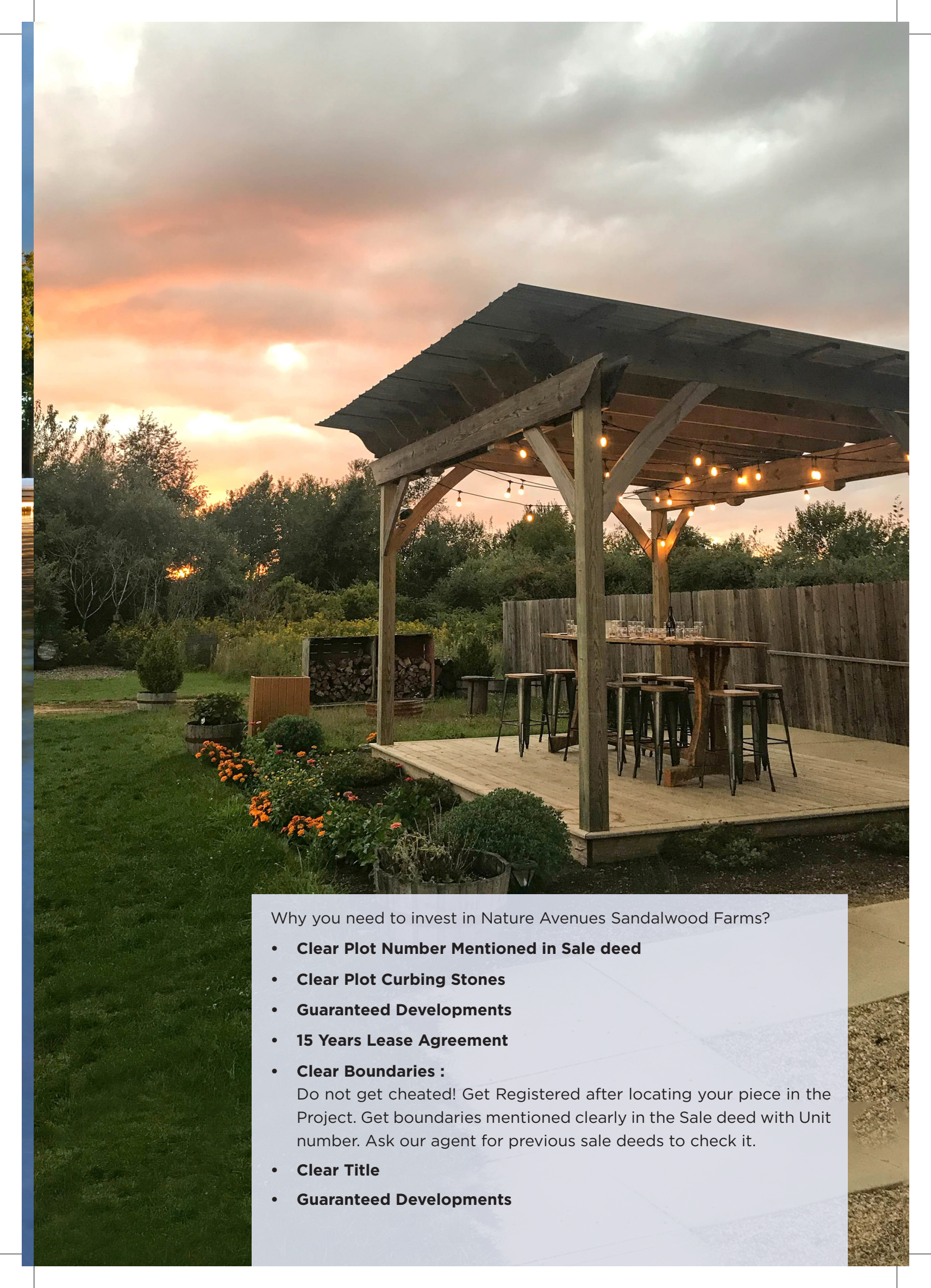

Why you need to invest in Nature Avenues Sandalwood Farms?

- **Clear Plot Number Mentioned in Sale deed**
- **Clear Plot Curbing Stones**
- **Guaranteed Developments**
- **15 Years Lease Agreement**

- **Clear Boundaries :**

Do not get cheated! Get Registered after locating your piece in the Project. Get boundaries mentioned clearly in the Sale deed with Unit number. Ask our agent for previous sale deeds to check it.

- **Clear Title**
- **Guaranteed Developments**

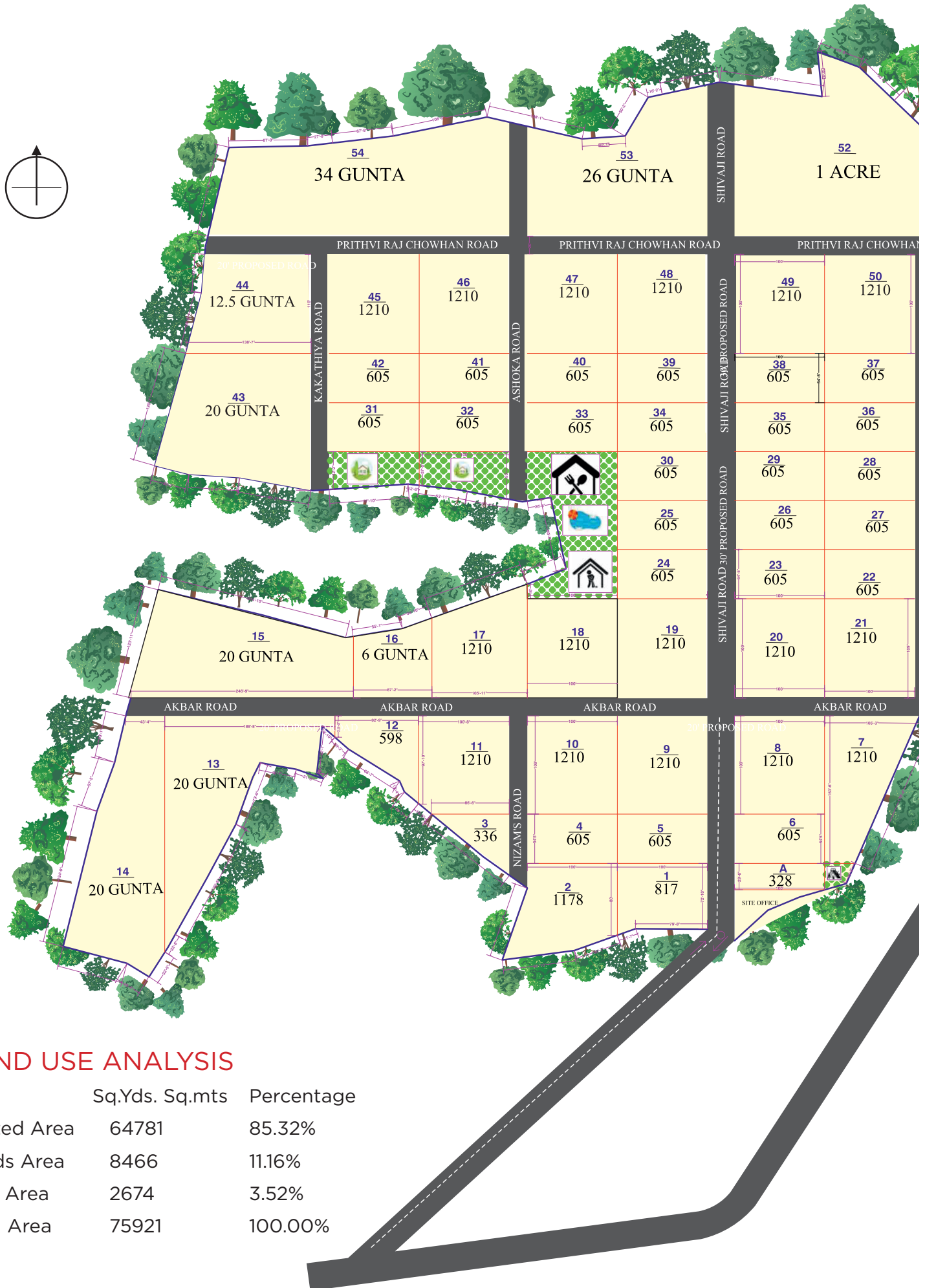

LAND USE ANALYSIS

	Sq.Yds.	Sq.mts	Percentage
Plotted Area	64781		85.32%
Roads Area	8466		11.16%
Club Area	2674		3.52%
Total Area	75921		100.00%





MAINTENANCE

- 15 Years maintenance
- CCTV Surveillance
- Immediate Plant Replacement
- Monitored by Agri Specialists
- Maintenance Charge Rs. 2,999 / 605 Sq. Yards
- 24/7 Security
- CCTV live broadcast via Website



PROFIT SHARING

- Customer Profit share : 50%
- Company Profit share : 50%
- Any other expenses other than maintenance will be shared equally in a 50:50 ratio.
- No income on fruits would be shared!

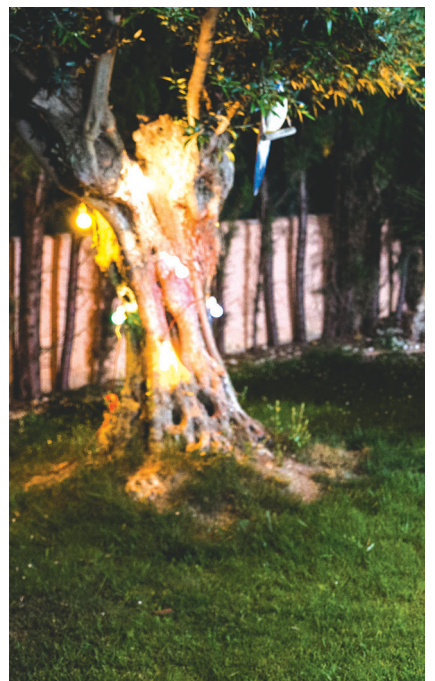



ROYAL'S ACRE FARM HOUSE

Plot Size : **4840 Sq. yards (One Acre)**

Features

Sandalwood Plants (350 Plants)

Fruit Plants (140 Plants)

2 BHK Cottage*

Swimming Pool*

Full Furnished Cottage*

Water Tank & Septic Tank

CCTV Monitoring

Lawn & Balcony

Maintenance*

Plot Size : **2420 Sq. yards (Half Acre)**

Features

Sandalwood Plants (170 Plants)

Fruit Plants (65 Plants)

1 BHK Cottage*

Swimming Pool*

Full Furnished Cottage*

Water Tank & Septic Tank

CCTV Monitoring

Maintenance*



Note : Cottage Construction cost extra.
Cost of the cottage designed based on the materials used, if any changes in material quality the customer has to borne extra charges!



LOCATION MAP

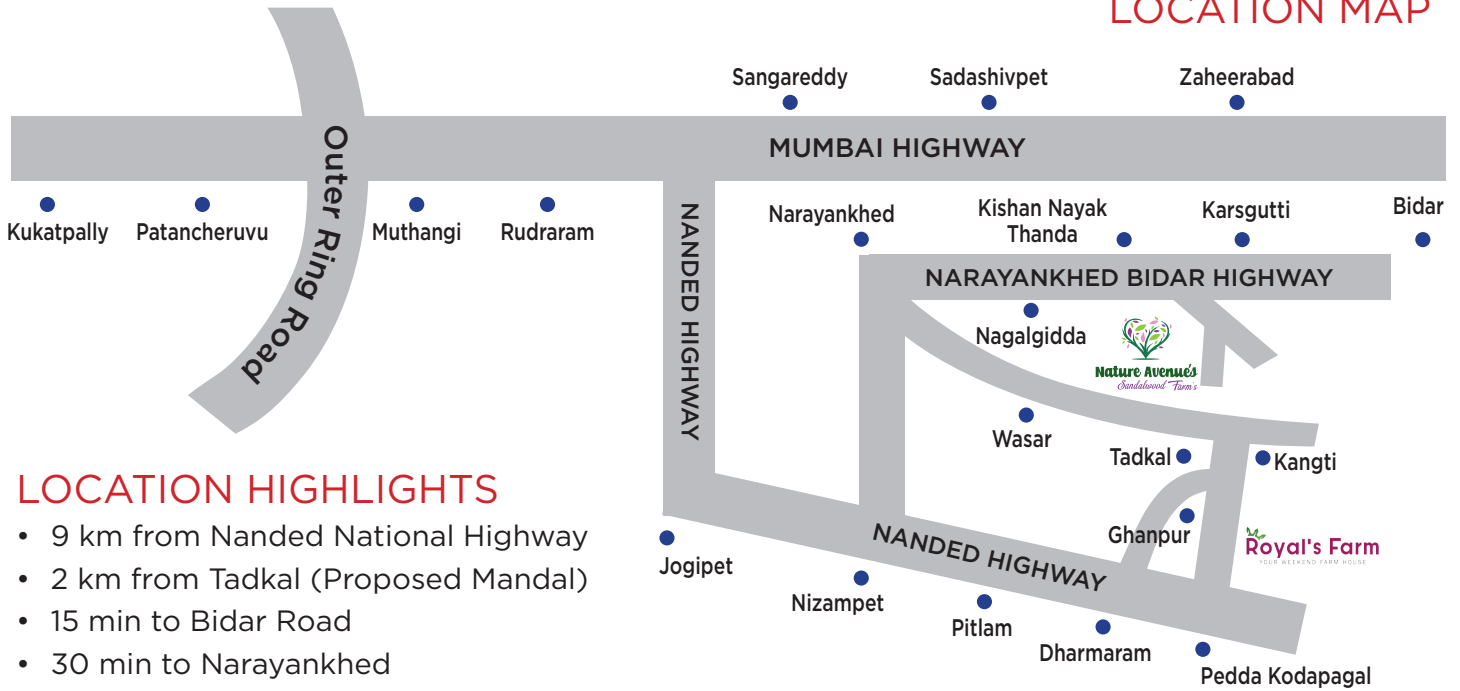

LOCATION HIGHLIGHTS

- 9 km from Nanded National Highway
- 2 km from Tadkal (Proposed Mandal)
- 15 min to Bidar Road
- 30 min to Narayankhed
- 45 min to NIMZ, Zaheerabad
- 45 min to Bidar Airport

ABOUT COMPANY

Crafting Telugu States' best developments

At Nature Avenues Sandalwood Farms, our passion is to create landmarks in the field of farm projects & upcoming residential projects! Epitomise the values of our family, and are built on a legacy of trust. We believe the curiosity of human beings to own a piece of land is to be fulfilled, and we have dedicated our services to delivering a well-developed, secured property to our customers!



Plot No. 121/EP,
Near Nagole Metro Station,
Pillar No. 809, Uppal Bhagat,
Backside Bharat Petrol Pump,
Uppal, Hyderabad - 500039
www.natureavenues.com

We are guided by our vision of "Promised. Delivered," and we are moving forward to make it better!

OUR SPECIALITIES :

- First in giving plot numbers in the sale deed*
- Launching with clear plotting*
- Offering the lowest price*
- Fast Developments*

CONTACT